

**FOR IMMEDIATE RELEASE**

# ADELAIDE CONTEMPORARY DESIGN PROPOSALS UNVEILED AS SIX STAR TEAMS COMPETE FOR THE CHANCE TO DESIGN A NEW SOUTH AUSTRALIA LANDMARK

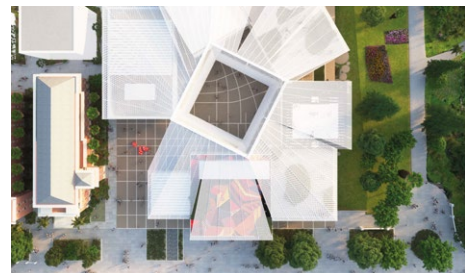

© Malcolm Reading Consultants and individual teams  
 Images from left to right: Adjaye Associates and BVN; BIG – Bjarke Ingels Group and JPE Design Studio; David Chipperfield Architects and SJB Architects; Diller Scofidio + Renfro and Woods Bagot; HASSELL and SO-IL; Khai Liew, Office of Ryue Nishizawa and Durbach Block Jagers

## Proposals displayed in online gallery on competition website and go on show at Art Gallery of South Australia

Arts South Australia today [12 May 2018] posted a digital gallery of the six concept designs devised by star international and Australian teams for a new landmark cultural destination, Adelaide Contemporary, which is intended to revitalise the former Royal Adelaide Hospital (oRAH) site.

The concept designs are now available to view on the international competition website at [competitions.malcolmreading.com/adelaidecontemporary/shortlist](http://competitions.malcolmreading.com/adelaidecontemporary/shortlist) and in a free-to-enter public exhibition at the Art Gallery of South Australia.

The unique cultural destination on Adelaide’s celebrated North Terrace boulevard will combine exhibition, research and education spaces with a public sculpture park and community meeting place.

In a world first, the *Gallery of Time* will curate South Australia's exceptional collection of Aboriginal art and cultures in conversation with work from European and Asian cultures, enabling visitors to look at Australian art in a global context.

Premier of South Australia Steven Marshall said the outcome of this competition will be integrated with the Government's broader vision for the oRAH site, including the National Aboriginal Art and Cultures Gallery.

**Premier of South Australia Steven Marshall said:**

*"We want to create on the oRAH site one of the most significant new arts and cultural destinations of 21st century Australia.*

*"Our plan will provide a national focal point for Aboriginal and Torres Strait Islander art and cultures as well as new spaces for major exhibitions, and the opportunity to unlock the hidden treasures of South Australia's cultural institutions.*

*"This truly unique and ground-breaking precinct is destined to become a beacon of artistic, cultural and architectural excellence internationally as a culmination of the long-held plans of the South Australian Museum and the Art Gallery of South Australia to better showcase their collections.*

*"The precinct is envisaged as an important economic driver for tourism and business investment creating new jobs and inspiring spin-off business initiatives."*

**Arts South Australia Executive Director Peter Louca said:**

*"Adelaide is regarded by many as overdue for a major new cultural infrastructure investment.*

*"The Government's policy supports the development of this proposal which will draw together long-held ambitions from cultural organisations like the Art Gallery of South Australia and the South Australian Museum.*

*"Their collections, the overwhelming majority of which are currently not accessible to the public, deserve to be showcased."*

**Michael Lynch AO CBE, chair of the jury and the Art Gallery of South Australia Board's newly appointed Special Advisor, said:**

*"This is one of the most important sites in Adelaide, and a landmark project that could set the city's compass for the next few decades, so we're delighted to reveal six possible futures from some of the most exciting and accomplished design teams in the world.*

*"Commissioning outstanding architecture is a way Adelaide can say to the world what a fantastic, dynamic city we have, and how deeply creativity is woven into our DNA. We have the art to put in the building; we have the appetite and momentum to make this happen."*

**Malcolm Reading, Competition Director, said:**

*“These proposals are all highly sophisticated. Some are more dramatic, some more subtle but all announce a destination and tantalise with the promise of an experience that is out of the ordinary.*

*“The winning design will be developed in close partnership with Arts South Australia and other stakeholders.”*

The six finalist teams were selected in December 2017, by a panel chaired by Michael Lynch AO CBE, from 107 teams made up of circa 525 individual firms applying from five continents.

The proposals on show are by the following high profile shortlisted teams (in alphabetical order):

**Adjaye Associates** (London, UK) **and BVN** (Sydney, Australia); **BIG – Bjarke Ingels Group** (Copenhagen, Denmark) **and JPE Design Studio** (Adelaide, Australia); **David Chipperfield Architects** (London, UK) **and SJB Architects** (Sydney, Australia); **Diller Scofidio + Renfro** (New York, USA) **and Woods Bagot** (Adelaide, Australia); **HASSELL** (Melbourne, Australia) **and SO-IL** (New York, USA); and **Khai Liew** (Adelaide, Australia), **Office of Ryue Nishizawa** (Tokyo, Japan) **and Durbach Block Jagers** (Sydney, Australia).

The jury, made up of nine eminent figures from the arts, architecture, culture and business (see Notes to Editors for full list) will subsequently meet to interview the teams and the winner announcement is expected later in the year, bringing to a close this stage of the project.

The former Art Gallery of South Australia Director, Nick Mitzevich, who has been appointed Director of the National Gallery of Australia with immediate effect, will be replaced on the jury by Assistant Director of Artistic Programs at the Art Gallery of South Australia, Lisa Slade. Michael Lynch AO CBE, chair of the jury, has been appointed as Special Advisor to the Art Gallery Board.

Adelaide is located on the traditional lands of the Kaurna people and the project site, close to the Art Gallery of South Australia and part of the former Royal Adelaide Hospital site, is rich in Kaurna heritage.

The conditions for Stage Two of the competition have been formally endorsed by the Australian Institute of Architects. Each team will receive an honorarium of AU\$90,000 for their competition work including their concept design.

For further updates please visit the competition website at

[competitions.malcolmreading.com/adelaidecontemporary/news](https://competitions.malcolmreading.com/adelaidecontemporary/news)

**Ends**



12 MAY 2018

MALCOLM  
READING  
CONSULTANTS

#### COMPETITION MEDIA ENQUIRIES

Malcolm Reading Consultants

Catherine Reading

[catherine.reading@malcolmreading.co.uk](mailto:catherine.reading@malcolmreading.co.uk)

+ 44 (0)207 831 2998

#### COMPETITION ENQUIRIES

Malcolm Reading Consultants

Oliver Finn

[adelaidecontemporary@malcolmreading.co.uk](mailto:adelaidecontemporary@malcolmreading.co.uk)

+44 (0)207 831 2998

#### ADELAIDE CONTEMPORARY MEDIA ENQUIRIES

Art Gallery of South Australia

Kate Griffith

[kate.griffith@sa.gov.au](mailto:kate.griffith@sa.gov.au)

+61 (0) 477 387 301

#### FOR IMAGES

Images of the concept designs can be downloaded here:

[dropbox.com/sh/iw428sldkpgjtno/AACXm-7tv24JqC1wWTOAOSena?dl=0](https://dropbox.com/sh/iw428sldkpgjtno/AACXm-7tv24JqC1wWTOAOSena?dl=0)

#### NOTES TO EDITORS

##### Adelaide Contemporary Exhibition

A free-to-enter public exhibition of the shortlisted concept designs is being held at the Art Gallery of South Australia in Adelaide from 12 May to 10 June.

##### Adelaide Contemporary International Design Competition Jury:

- **Michael Lynch AO CBE (Chair)**, Chair, Sydney Community Foundation and Chair, Circa
- **Lee-Ann Tjunypa Buckskin**, Deputy Chair, Australia Council for the Arts, Managing Director, L-AB & Associates and Executive, Aboriginal Strategy, South Australian Film Corporation
- **Beatrice Galilee**, Daniel Brodsky Associate Curator of Architecture and Design, The Metropolitan Museum of Art, New York
- **Walter Hood**, Creative Director and Founder, Hood Design Studio
- **David Knox**, Deputy Chair, Economic Development Board of South Australia and Member, Adelaide Botanic Gardens Foundation Committee
- **Toshiko Mori**, Founder and Principal, Toshiko Mori Architect and Robert P. Hubbard Professor in the Practice of Architecture at Harvard University Graduate School of Design
- **Lisa Slade**, Assistant Director, Artistic Programs, Art Gallery of South Australia
- **Sally Smart**, Vice-Chancellor's Professorial Fellow, University of Melbourne and renowned contemporary artist
- **Tracey Whiting**, Chair, Art Gallery of South Australia Board



The competition jury will be advised by **Malcolm Reading**, Competition Director, and fully supported by a panel of technical advisers.

**Jury Biographies** are available on the competition website at:

[competitions.malcolmreading.com/adelaidecontemporary/jury](https://competitions.malcolmreading.com/adelaidecontemporary/jury)

**Full Details of Shortlisted Teams** (in alphabetical order by lead consultant):

- **Adjaye Associates and BVN** with McGregor Coxall, Steensen Varming, Plan A Consultants, Barbara Flynn, Yvonne Koolmatrie, Aurecon Group and Front Inc
- **BIG – Bjarke Ingels Group and JPE Design Studio** with United Natures, Arketype, BuildSurv, Virtual Built, Future Urban Group, Lewis Yerloburka O’Brien, Marijana Tadic, Erica Green, Peter Dungey, Brian Parkes and Lindy Lee
- **David Chipperfield Architects and SJB Architects** with Jane Irwin Landscape Architecture and Arup Lighting
- **Diller Scofidio + Renfro and Woods Bagot** with Oculus, Pentagram, Right Angle Studio, Klynton Wanganeen, Dustin Yellin, Studio Adrien Gardère, Australian Dance Theatre, Deloitte, Ekistics and Katnich Dodd
- **HASSELL and SO-IL** with Ali Cobby Eckermann, Arup, Australian Industrial Transformation Institute, Fabio Ongarato Design, Fiona Hall and Mosbach Paysagistes
- **Khai Liew, Office of Ryue Nishizawa and Durbach Block Jagers** with Masako Yamazaki, Mark Richardson, Arup, Irma Boom, Taylor Cullity Lethlean and URPS

**Team Profiles (as supplied by teams)** available at:

[competitions.malcolmreading.com/adelaidecontemporary/news/2017/adelaide-contemporary-international-design-competition-shortlist-announced](https://competitions.malcolmreading.com/adelaidecontemporary/news/2017/adelaide-contemporary-international-design-competition-shortlist-announced)



12 MAY 2018

## Arts South Australia

Arts South Australia is the State Government agency charged with supporting the making of work by South Australian artists, the national and international promotion of South Australian art, and the care of the State's collections and the buildings and assets that house them.

The State Government recognises and capitalises on economic opportunities arising from the diverse arts and cultural organisations, practitioners, events and physical assets in the State by developing programmes that build on cultural heritage and creativity, and providing financial support to the creative industries.

Arts and cultural development in South Australia is characterised by a diversity of practice and practitioners, unique and historic assets and facilities, world renowned collections and a commitment to arts for all, regardless of geographic location or circumstance.

For more information visit

[arts.sa.gov.au](http://arts.sa.gov.au)

## Malcolm Reading Consultants

Malcolm Reading Consultants (MRC) is a strategic consultancy that helps clients to imagine and define contemporary environments, both built and natural. MRC is the leading specialist in devising and managing design competitions internationally. MRC believes in the power of design to create new perceptions and act as an inspiration.

Recent work includes competitions for the Illuminated River Foundation (UK), the M.K. Čiurlionis Concert Centre (Lithuania), the Royal College of Art (UK), the V&A (UK), the Mumbai City Museum (India), Gallaudet University (USA), Art Mill (Qatar) and new buildings in the UK for New College, Oxford and Homerton College, Cambridge.

MRC is currently running the design competition for University College Dublin's Future Campus, as well as working on invited competitions. The consultancy is also advising Exeter College, Oxford and preparing the British Library's Design Brief for London's Knowledge Quarter.

For more information visit

[malcolmreading.com](http://malcolmreading.com)